

## RD-232 Remote Display



RD-232 NEMA 4X stainless steel wall mount enclosure



RD-232 compact stainless steel wall mount enclosure



### Standard Features

- NEMA 4X Fiberglass-Reinforced Polyester (FRP) wall-mount enclosure
- Optional NEMA 4X stainless steel wall-mount enclosure or NEMA 12 panel-mount version
- Easy-to-read 6-digit 0.8" (20.3 mm) Light Emitting Diode (LED)
- AC or DC operation
- 4 status annunciators
- Full floating decimal point
- RS-232 or 20 mA current loop active or passive interface
- Compatible with a variety of digital weighing indicators; DIP switch selectable intuitive data receiver interprets serial strings

### Specifications

#### DISPLAY:

6-digit, 7-segment, 0.8" (20.32 mm) Light Emitting Diode (LED)

#### STATUS ANNUNCIATORS:

lb, kg, gross, net

#### OPERATING VOLTAGE:

115 VAC/12 VDC,  $\pm 10\%$  60Hz, 230 VAC available  
DC Voltage Range: 6.2-18 VDC

#### INPUT INTERFACE:

RS-232, 20 mA active or passive current loop, standard ASCII compatible

#### BAUD RATE:

Selectable: 300, 600, 1200, 2400, 4800, 9600, 19,200

#### OPERATING TEMPERATURE:

-13°F to 104°F (-25°C to 40°C)

#### RATING/MATERIAL:

NEMA 4X FRP or optional stainless steel

#### WEIGHT:

Approximately 5 lb (2.3 kg)  
Stainless steel unit, approximately 6 lb (2.7 kg)

#### WARRANTY:

1-year limited warranty

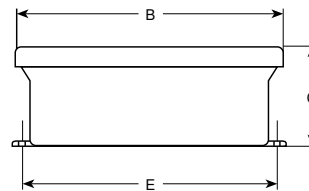
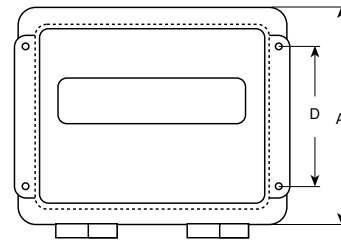

### RD-232

PART #	DESCRIPTION	EST. SHIP WEIGHT
32716 ....	RD-232, 115 VAC/12 VDC, FRP enclosure .....	5 lb
68786 ....	RD-232, 115 VAC/12 VDC, compact stainless steel enclosure.....	5 lb
32717 ....	RD-232, 115 VAC/12 VDC, NEMA 4X stainless steel enclosure ..	8 lb
32727 ....	RD-232, 115 VAC/12 VDC, panel mount .....	3 lb
34748 ....	RD-232, 230 VAC/12 VDC, FRP enclosure .....	5 lb

Specify interfacing indicator when ordering a remote display

#### Options/Accessories

- 32726 .... RD-232, 115 VAC/12 VDC board only
- 33210 .... Additional operating manual (RD-232/RD-300)

### DIMENSIONS

FRP Enclosure	Stainless Steel Enclosure
A = 8.00" (203.2 mm)	A = 6.00" (152.4 mm)
B = 9.50" (241.3 mm)	B = 9.50" (241.3 mm)
C = 5.25" (133.4 mm)	C = 3.87" (98.3 mm)
D = 4.00" (101.6 mm)	D = 4.00" (101.6 mm)
E = 8.75" (222.3 mm)	E = 8.75" (222.3 mm)
Compact Enclosure	Panel Mount
A = 6.25" (158.7 mm)	A = 5.88" (149.3 mm)
B = 9.25" (234.9 mm)	B = 7.88" (200.1 mm)
C = 2.00" (50.8 mm)	C = 2.00" (50.8 mm)
D = 5.25" (133.3 mm)	D = 5.12" (130.2 mm)
E = 8.50" (215.9 mm)	E = 7.12" (180.9 mm)